

CALYPSO

Motor drive system for swimming pool bar covers

FR | PAGE 1 - EN | PAGE 5

ASSEMBLY INSTRUCTION AND RECOMMENDATIONS FOR USE

To be read carefully and kept for future reference.

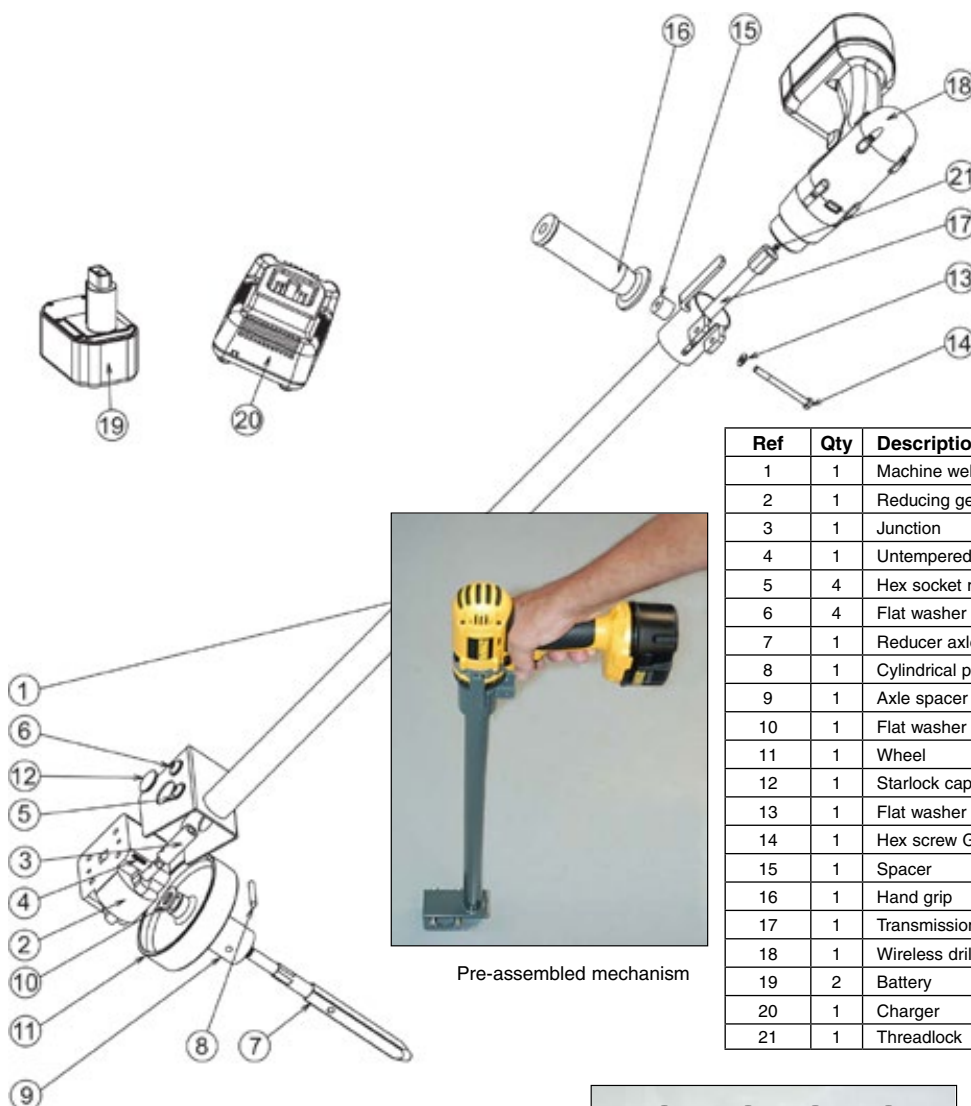

Ref	Qty	Description
1	1	Machine welded chassis
2	1	Reducing gear 1:13
3	1	Junction
4	1	Untempered cylindrical pin - type B 4x16 BN684 DIN7
5	4	Hex socket round head screw M8-12
6	4	Flat washer type M Ø8 BN50080 NFE 25.514
7	1	Reducer axle
8	1	Cylindrical pin type A 6x40 BN1351 DIN7343
9	1	Axle spacer
10	1	Flat washer Ø14
11	1	Wheel
12	1	Starlock cap, Ø12
13	1	Flat washer type M Ø6 BN50080 NFE 25.514
14	1	Hex screw Gr A M6 x 70mm BN623 DIN931
15	1	Spacer
16	1	Hand grip
17	1	Transmission shaft
18	1	Wireless drill 984 DC
19	2	Battery
20	1	Charger
21	1	Threadlock

Pre-assembled mechanism

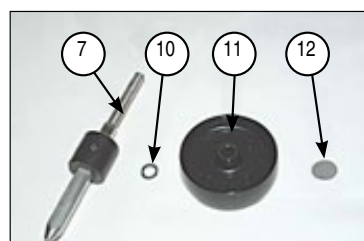

Parts of the reducing axle assembly

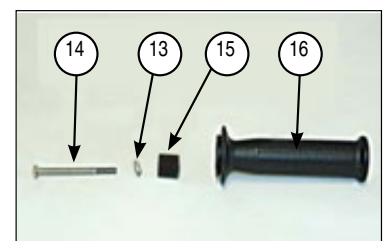

Parts of the hand grip assembly

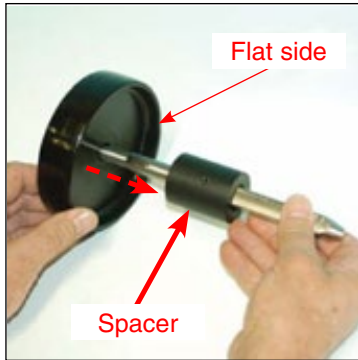

Thread the wheel onto the reducing axle, positioning the flat side against the spacer.

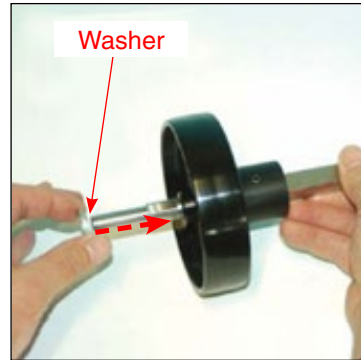

Slide the washer onto the axle against the wheel.

Decide on the initial position of the motor drive system (to the right or the left with respect to the cover), and continue assembly according to this position

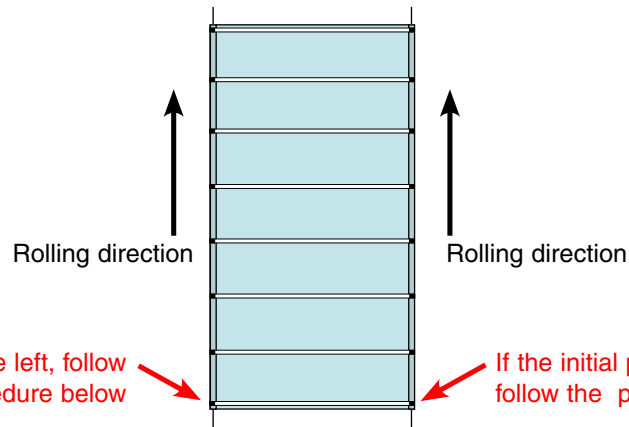

If the initial position is on the left, follow the procedure below

If the initial position is on the right, follow the procedure below

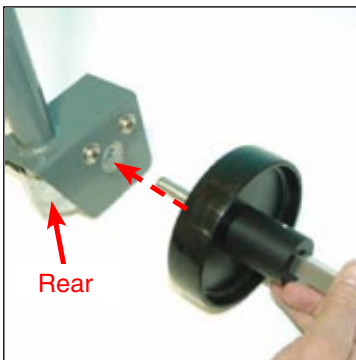

Insert the axle through the reducing gear, passing from right to left. The rear of the reducing gear is rounded.

Insert the axle through the reducing gear, passing from left to right. The rear of the reducing gear is rounded.

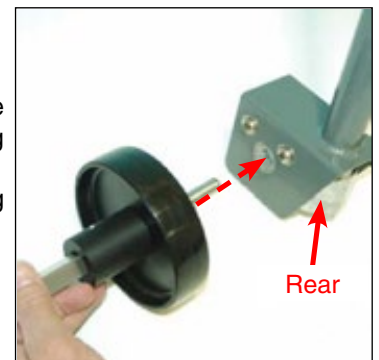

Using a mallet, clip the Starlock cap into the groove at the end of the axle to hold the assembly in position.



ASSEMBLY OF THE HAND GRIP

Attach the hand grip underneath the motor. **It should be on the side opposite the wheel.** The assembly illustrated opposite shows the hand grip when the initial position is to the left.

Fasten it in position using the hex screw Gr A M6 x 70mm and washer (ref 13 and 12 page 6), having first inserted the spacer (ref 14) between the hand grip and its support.

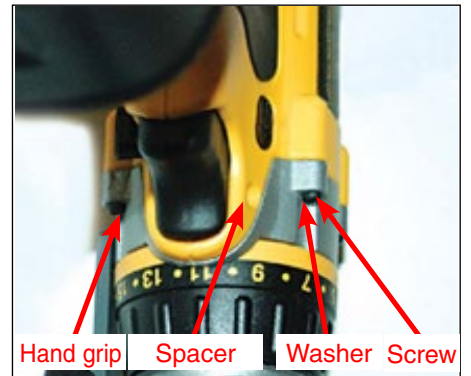

TO MODIFY THE INITIAL POSITION, DISASSEMBLE THE MOTOR DRIVE SYSTEM BY CARRYING OUT THESE STEPS IN THE REVERSE ORDER AND ASSEMBLE AGAIN FOLLOWING THE RELEVANT INSTRUCTIONS ON PAGE 3.

MOTOR SETTINGS

The motor settings should be as follows:

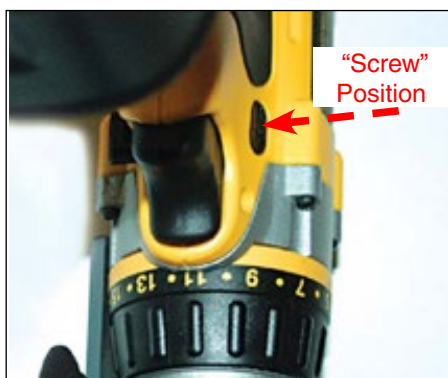
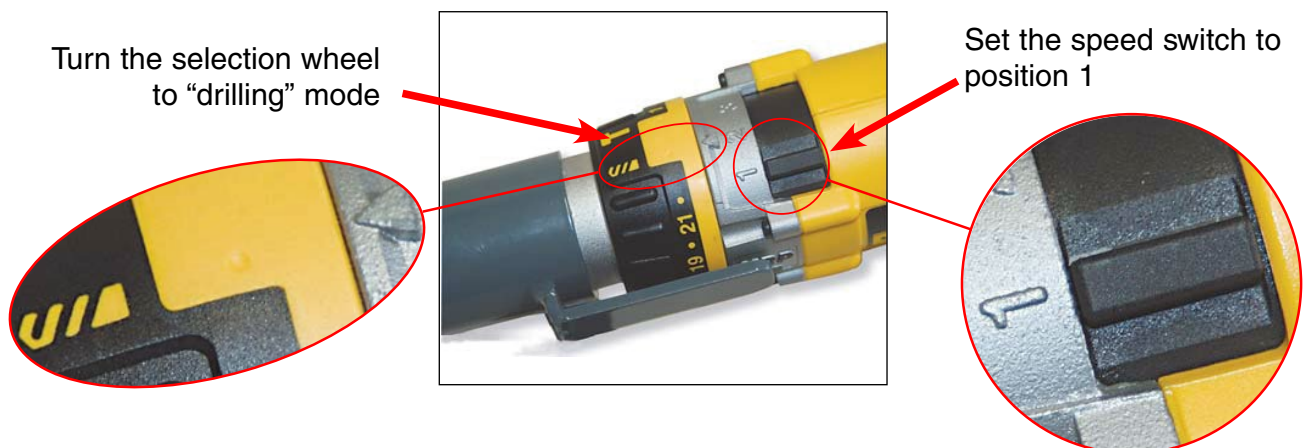

Push the rotation inverter to «screw» (all the way to the left).

THE SETTINGS SHOULD ALWAYS BE AS DESCRIBED ABOVE

THE MOTOR DRIVE SYSTEM IS READY TO BE USED

CHARGING THE BATTERIES

The motor drive system is delivered with 2 battery packs, their autonomy is determined by the cover dimensions and the roll frequency (as a general guide, approximately 10 rolls for a 9 x 4 m cover).

Each battery pack must be charged before its first use. The time required for a full charge is approximately 1 hour.

To charge a battery pack, insert it in the charger. The battery pack should be inserted fully, without forcing it in.

The red LED will start to blink. After about 1 hour, the blinking stops and the LED is lit continuously indicating that the battery pack is fully charged. The charger automatically switches to compensation mode. After approximately 4 hours, it finally switches to trickle charge mode.

The battery pack can be removed at any time, or left in the charger indefinitely.

A rapidly blinking LED indicates that there is a charging problem. Replace the battery pack in the charger, or try another one.

**Rotate between the two battery packs.
A battery pack that is stored without being used will deteriorate rapidly.**

Important:

- Do not charge the battery packs at ambient temperatures lower than 4 °C or higher than 40 °C. Recommended charging temperature: approximately 24 °C.
- Only use DEWALT DE9092 battery packs.
- Dispose of battery packs responsibly.

Battery lid

A lid covers the battery pack contacts. While the cover is not in place, a metallic object could cause a short circuit across the contacts, leading to a risk of fire and damage to the battery pack.

- Remove the protective lid before putting the battery pack in the charger or in the motor.
- Place the protective lid over the contacts as soon as it is removed from the charger or motor.
- Check that the protective lid is correctly positioned before storing or transporting a battery pack.

Trickle mode

Trickle mode is used to preserve the maximum capacity of the battery pack. This function should be used every week or every 10 charging cycles.

- Start the charging process as described previously.
- When the LED stops blinking, leave the battery pack in the charger for approximately 4 hours.

TECHNICAL DATA			
Motor		Charger	
Voltage	14.4 volts	Mains voltage	230 V
Fuse	10 A	Time to charge	approximately 60 minutes
Battery pack NicD - DE9092		Weight	0.4 kg
Voltage	14.4 V	Noise	
Capacity	2.4 Ah	Acoustic pressure	87 dB(A) at the operator's ears
Weight	0.7 kg	Acoustic power	100 dB(A)

OPERATING THE MOTOR DRIVE SYSTEM

The motor drive system should only be used to roll the cover up. The cover is unrolled by pulling on the transversal strap.

- Insert the motor drive system fully into the square recess on the end bar.
- Actuate the motor, holding the motor drive system vertically at least during the first turns to stop the reduction gear rubbing against the ground. The speed of operation can be controlled by placing more or less pressure on the motor trigger.
- Roll the cover up as evenly as possible.

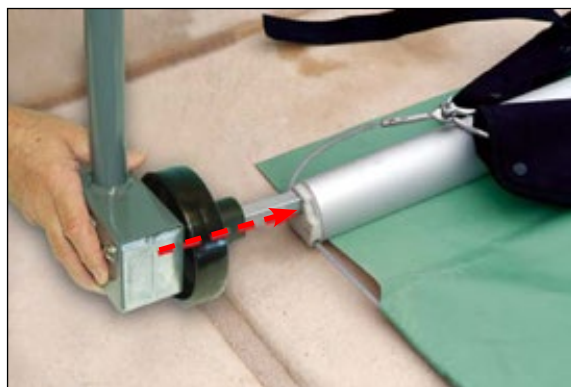

GUARANTEE CONDITIONS

THE CALYPSO MOTORISED CRANK (AVAILABLE AS AN OPTION) IS COVERED BY A 1 YEAR GUARANTEE. THE BATTERY PACKS ARE NOT COVERED BY ANY GUARANTEE

